

# Millie & Jones.

## Assembly Guide

### **Before Assembly**

- Check Parts - Unpack and ensure all parts are included and undamaged.
- Read Instructions - Review the guide fully before starting.
- Prepare the Space - Clear the area and assemble on a soft surface to prevent damage.
- Gather Tools - Use only the recommended tools.
- Get Help - Larger items may require two people.

### **Health & Safety**

- Keep Kids & Pets Away - Ensure a safe workspace.
- Lift Safely - Avoid strain; lift with care or get assistance.
- Wear Protection - Gloves help prevent injuries.
- Secure Loose Clothing - Avoid anything that could get caught.
- Handle Small Parts Carefully - Keep screws and fittings away from children.
- Dispose of Packaging Safely - Recycle and keep plastic bags out of reach.

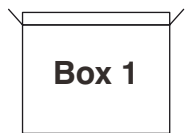

**Box 1**

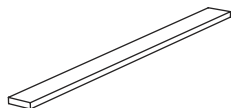

**H. Slats(x26)**

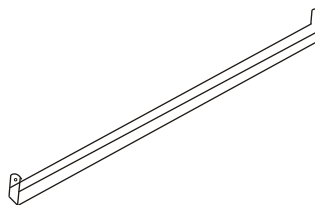

**T. Bed Cross Bar(x4)**

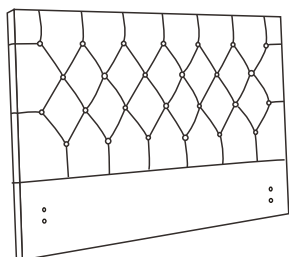

**A. Headboard (x1)**

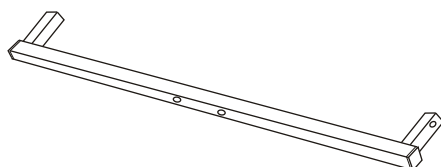

**W. Front and Back Frame Rail(x2)**



**X. Cross Support Bar(x2)**

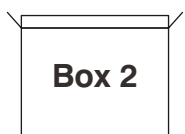

**Box 2**

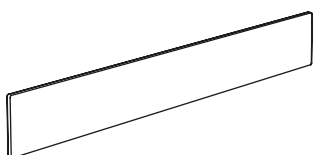

**B. Side Rails (x2)**

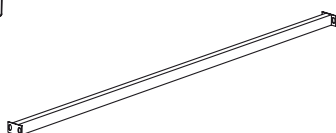

**C. Centre Support Rail (x1)**



**D. Left & Right Frame Rail (x2)**

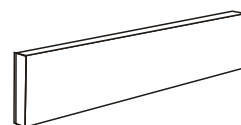

**F. Footboard (x1)**

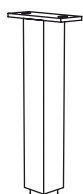

**G. Support Leg (x1)**



**I. Legs (x4)**



**Q Slat Caps (x26)**



**R. Centre Slat Caps (x13)**



**E. metal hook (X2)**

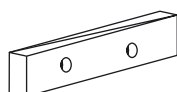

**B1. Baton (x1)**

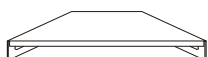

**V. corner bracket (X4)**



**U. Pull Strap (x1)**



**O. M5 Allen Key (x1)**

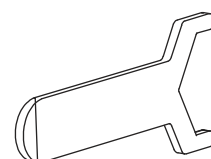

**P. Spanner (x1)**



**C1. M4 Allen Key (x1)**

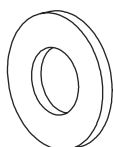

**M. Flat Washer (X8)**



**N. Spring Washer (x8)**

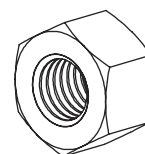

**K. Nuts (x12)**

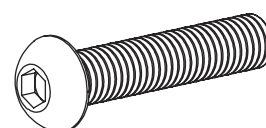

**L. M8x45mm Bolts (x4)**

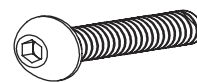

**Y M6x16mm Bolts (x16)**

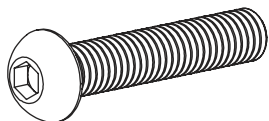

**S. M8x40mm Bolts (x6)**

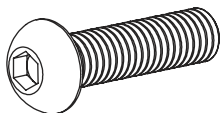

**J. M8x30mm Bolts (x8)**

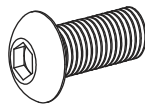

**Z. M8x16mm Bolts (x4)**

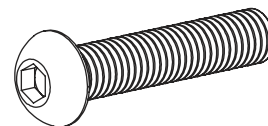

**A1. M8x65mm Bolts (x4)**

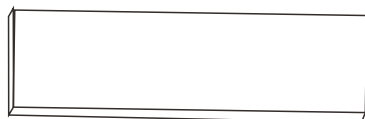

**D1. Support Board (X2)**

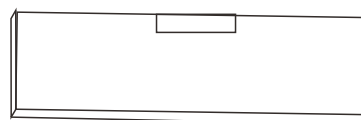

**E1. Support Board (X2)**

## Step 1

Unpack all components from the boxes and check you are not missing anything. Please check these against the list on page 3 & 4. Should you identify any missing components, please contact the retailer you purchased the bed from.

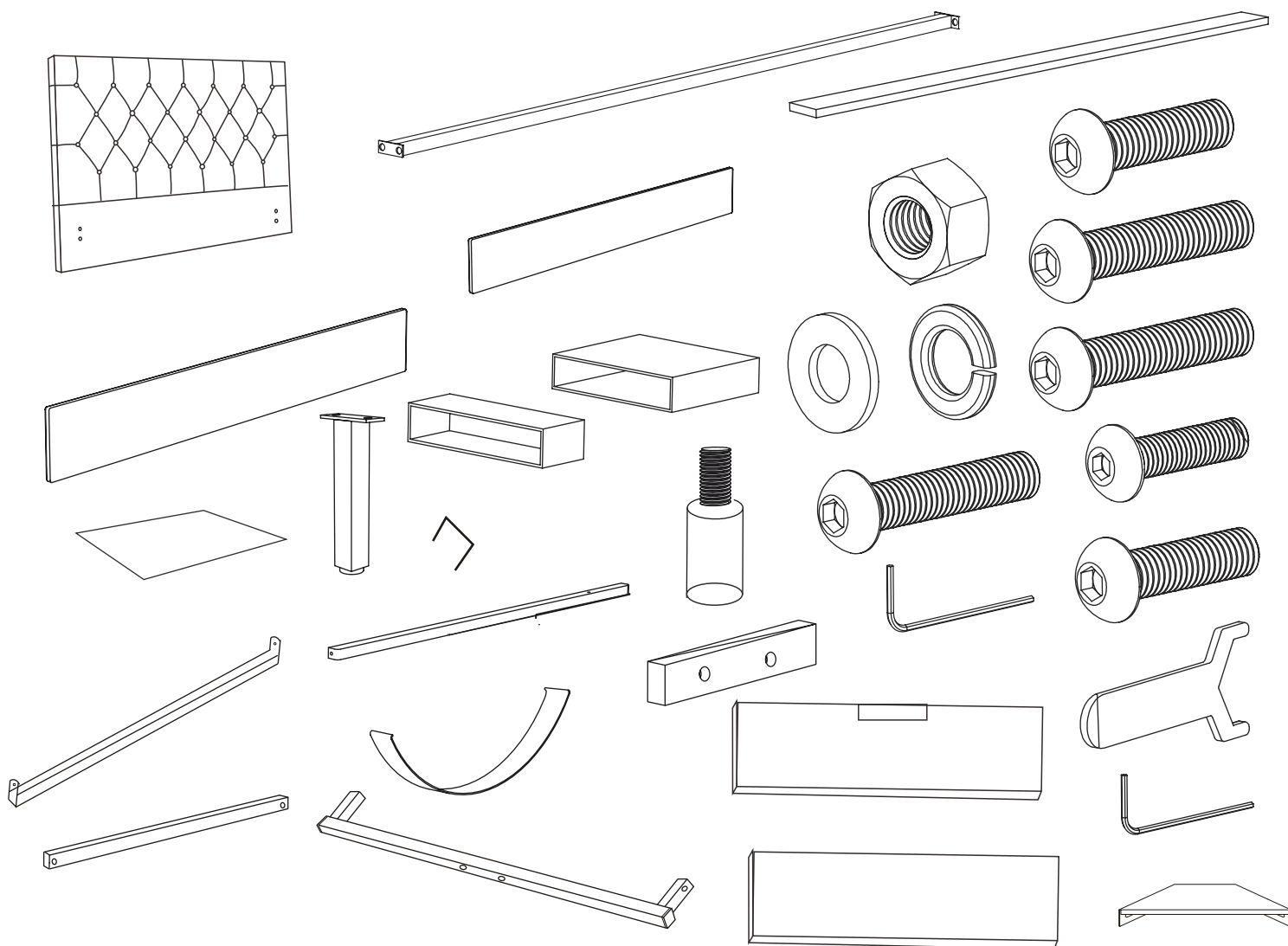

## Step 2

Attach 2x Legs (**I**) to the 1x Headboard (**A**) and then attach 2x Legs (**I**) to the 1x Footboard (**F**). Please do not use any power tools for this assembly as it will void your guarantee.

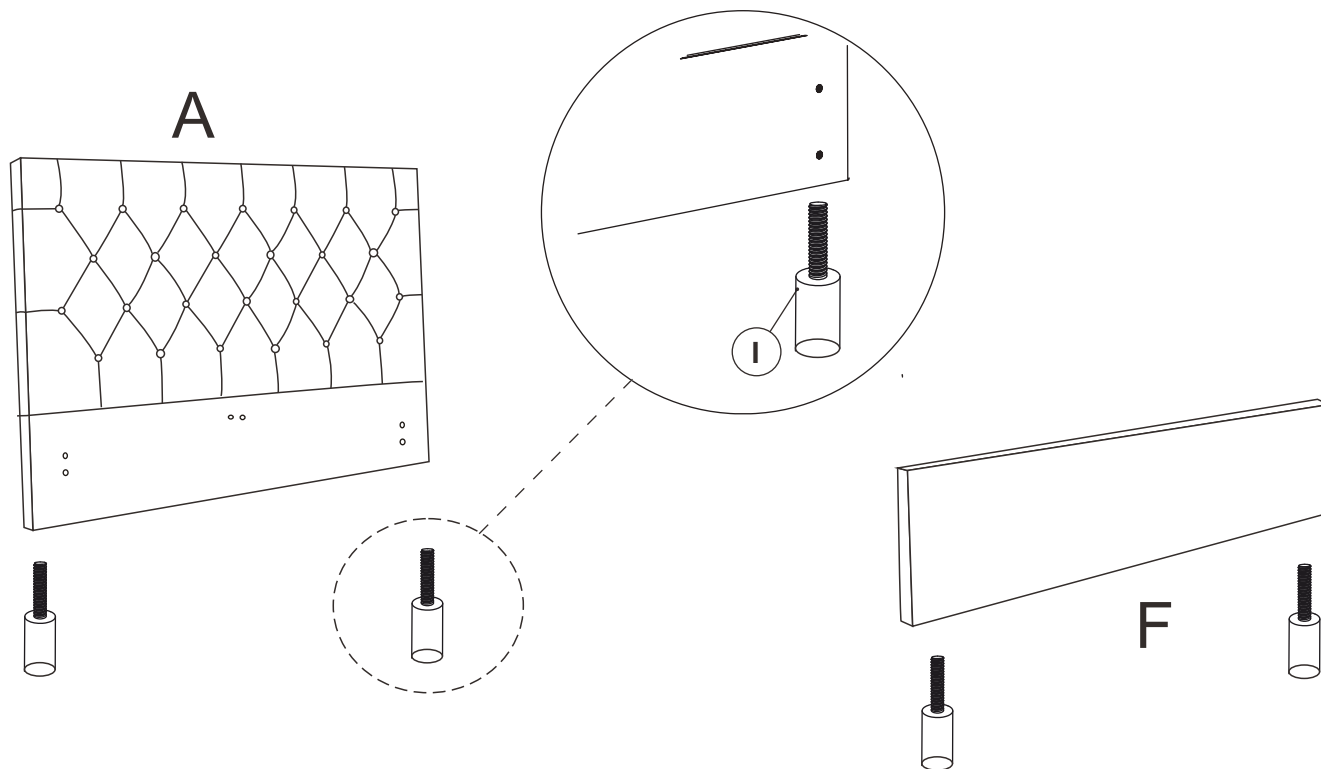

## Step 3

Attach 2x Side Rails (**B**) to 1x Headboard (**A**) and 1x Footboard (**F**) using 8x M8x30mm Bolt (**J**), 8x Spring Washer (**N**), 8x Flat Washer (**M**) and 1x M5 Allen Key (**O**).

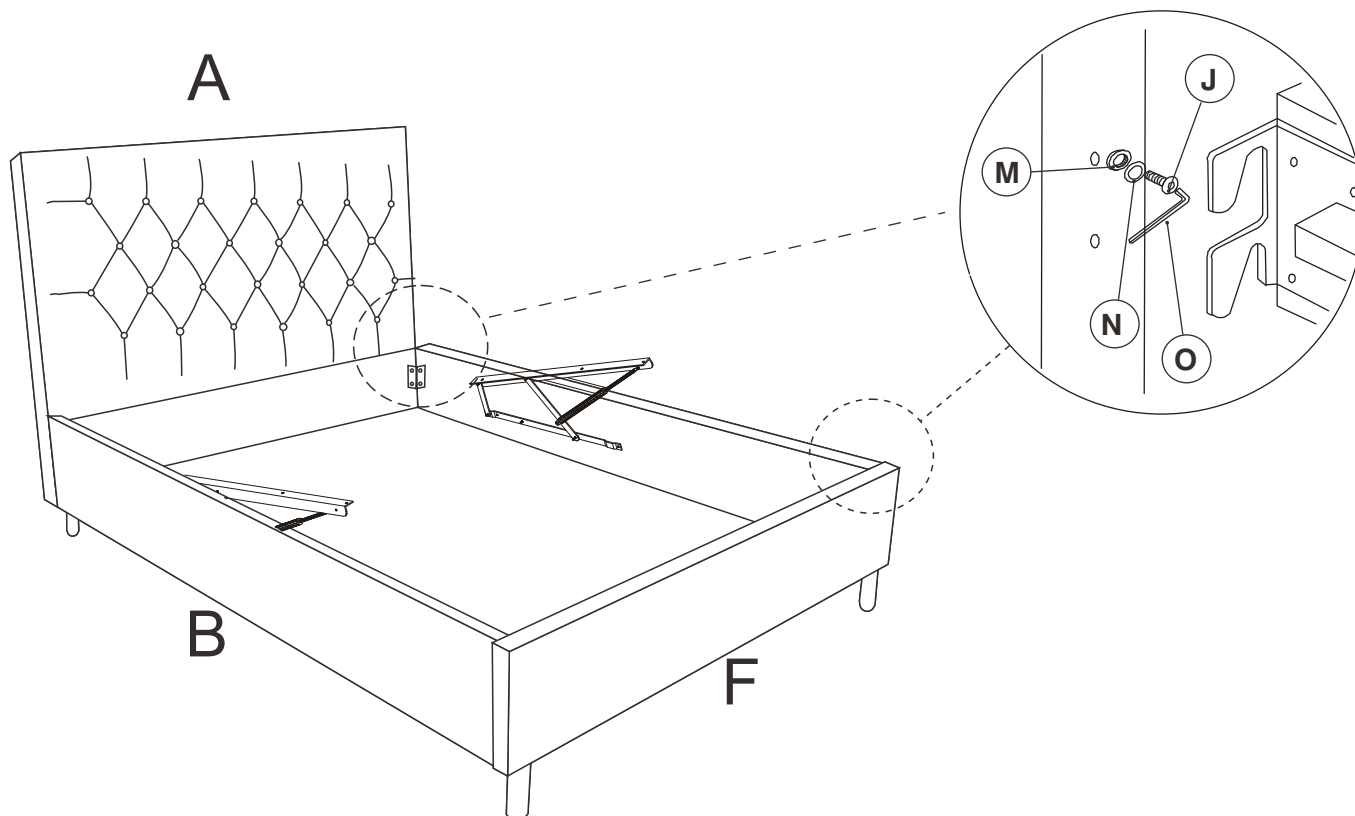

## Step 4:

To attach the corner bracket (V) to the headboard(A), footboard(F) and side rails(B) you will need to use hardware parts 8X M6x16mm Bolts (Y) and the M4 allen key(C1).

To fix the 4 X bed cross bar(T) to the side rails ,you will need to use hardware 8X M6x16mm Bolts (Y) and the M4 allen key(C1).

**DO NOT use any power tools as this may damage the bed frame and will invalidate any claims.**

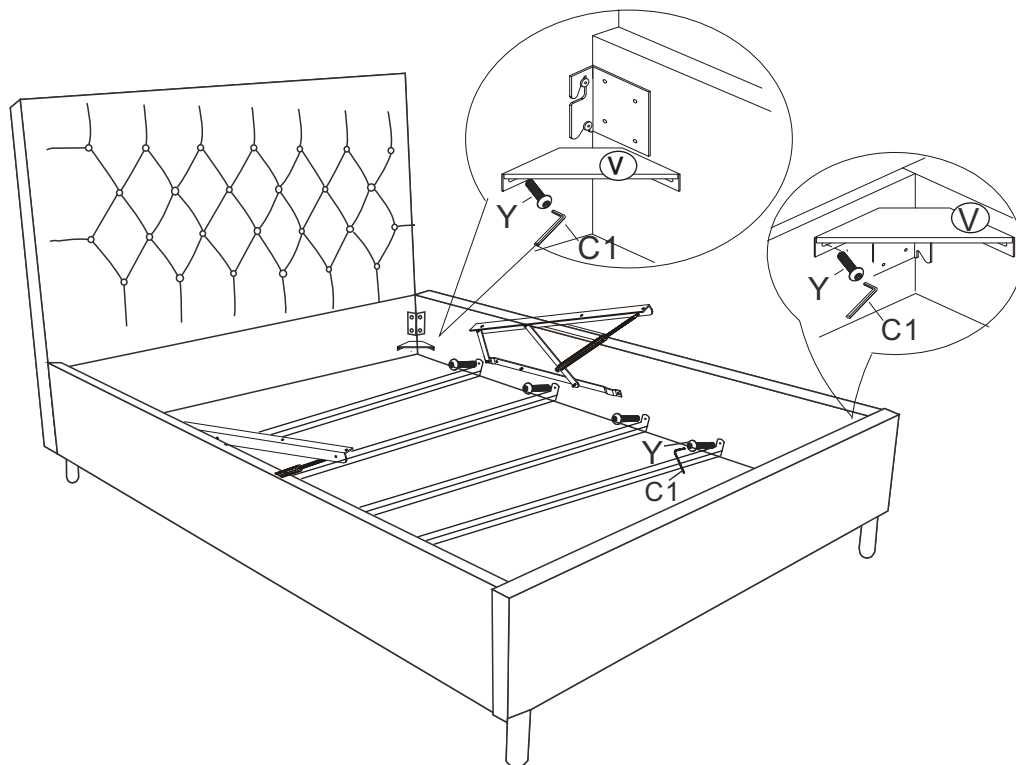

## Step 5:

Fix Support Boards 2X(D1) and 2X(E1) to above the Bed Cross Bars (T)

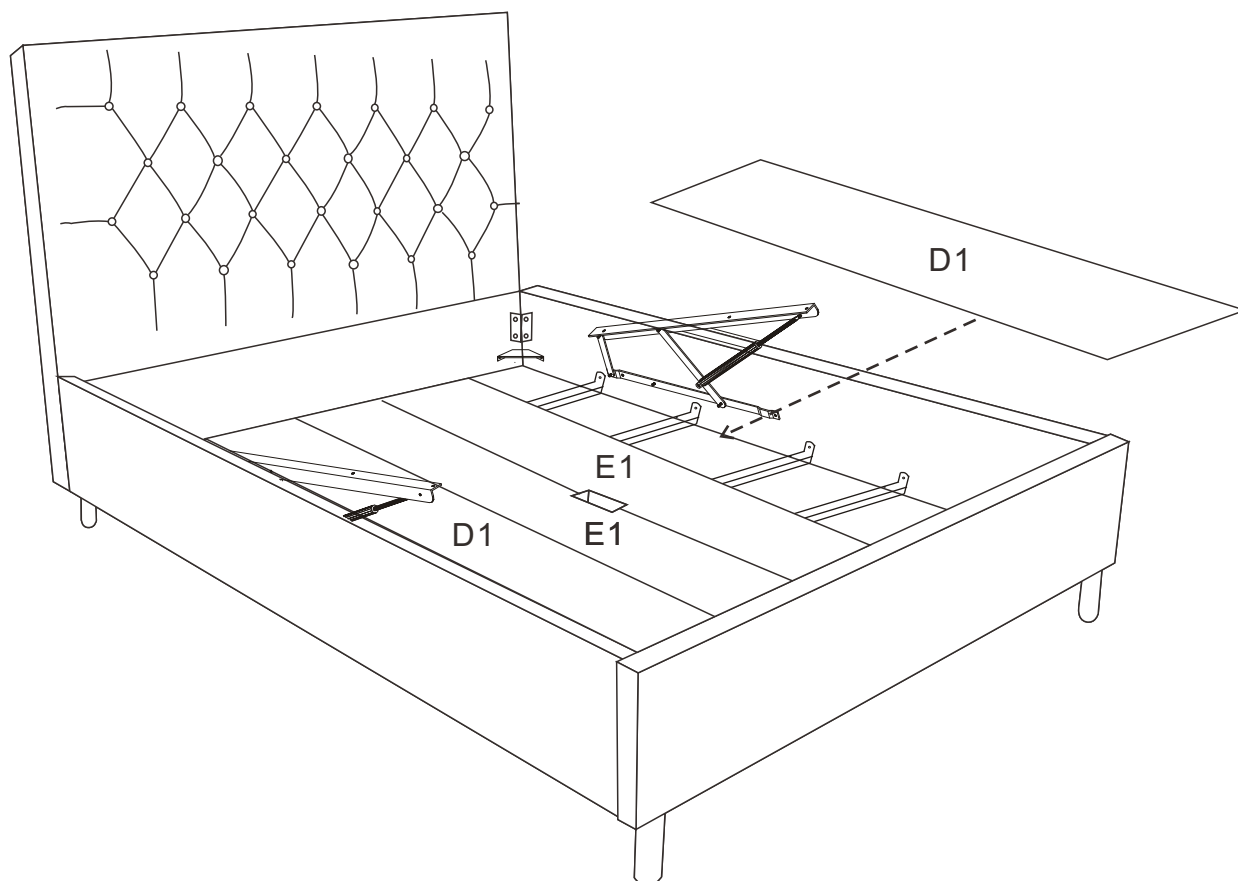

## Step 6

To attach the front frame rail(W)and back frame rail (W) to the left frame rail (D)and right frame rail(D), you will need hardware parts 4 X M8x16mm Bolts (Z) with the M5 allen key(O).

To attach the centre support bar (C) to the front frame rail(W)and back frame rail(W),you will need hardware parts 4X M8x40mm Bolts(S) and 4X Nuts (K) with the M5 allen key(O) and the spanner(P).

To attach the support leg (G) to the centre support bar(C),you will need hardware parts 2X M8x40mm Bolts(S) and 2X Nuts (K) with the M5 allen key(O) and the spanner(P).

Insert the metal hook(E) to the front frame rail(W).

**DO NOT use any power tools, this may damage the bed frame and will invalidate any claims.**

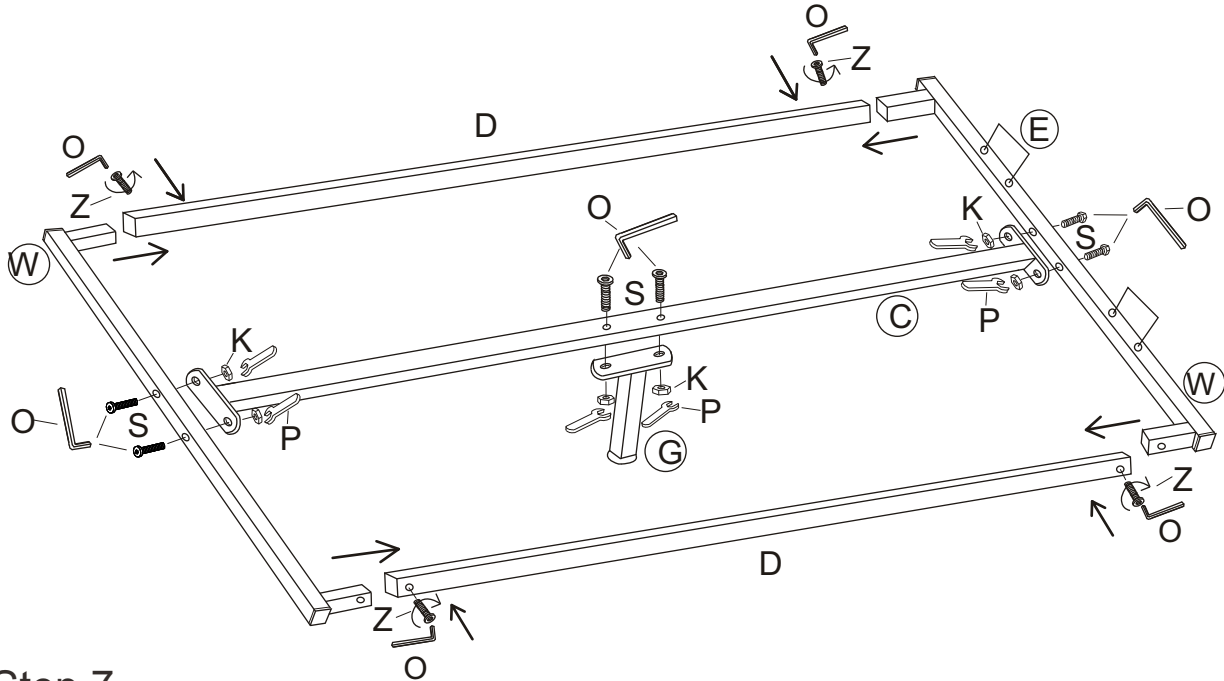

## Step 7

To attach the metal frame(W/C/D) and cross support bar(X)to the gas lift pre-fixed to the side rails, you will need to use hardware parts 4X M8x65mm Bolts(A1) , 2 XM8x45mm Bolts(L) and 6x Nuts (K) with the M5 allen key(O) and the spanner(P).

To attach the Baton (B1)TO the footboard(F) you will need to use hardware parts 2xM8x45mm Bolts(L)with the M5 allen key(O) .

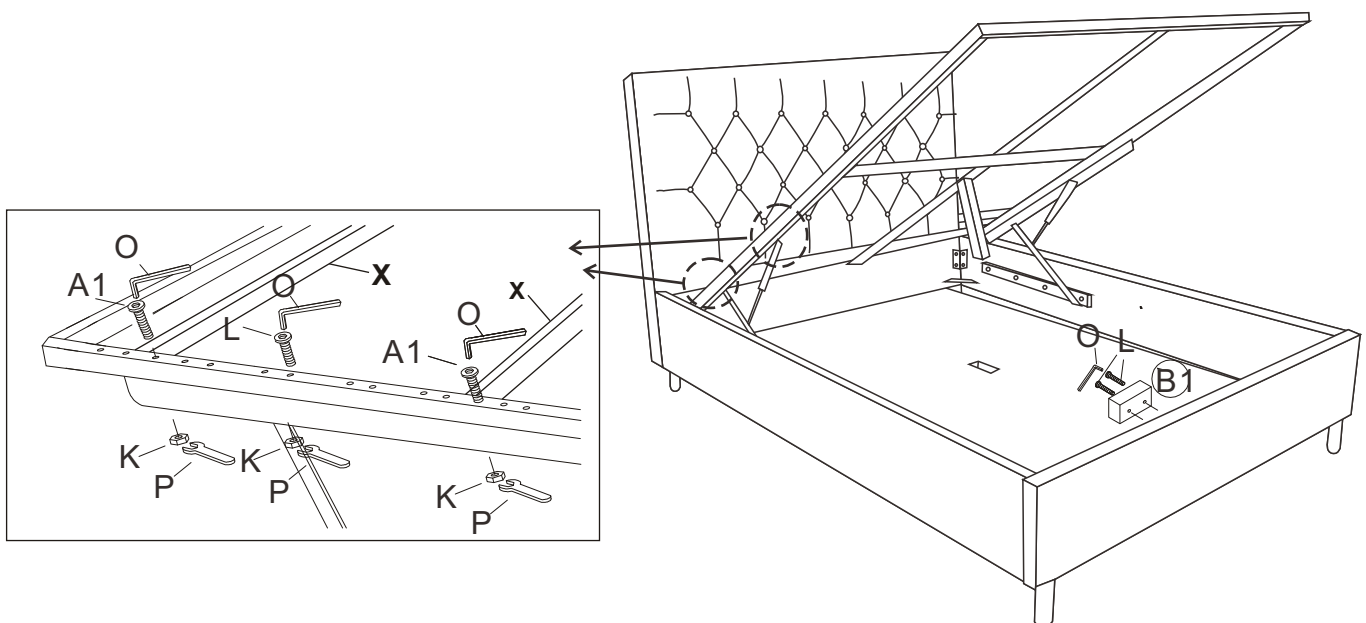

## Step 8

Slot each Slat Cap (Q) onto the end of each Slat (H), then slot each Slat (H) into each Centre Slat Cap (R). Press firmly into each slat rail located on the inside of the side rails (B) and then into the Centre Support Rail (C).

